

ATUL VIDYA MANDIR WARDHA'S



## RAJARSHEE SHAHU SCIENCE COLLEGE

Chandur Railway, Dist. – Amravati, Maharashtra



*Affiliated to*

**Sant Gadge Baba Amravati University, Amravati**



**2<sup>nd</sup> Cycle**

# **Assessment & Accreditation by NAAC**

### **CRITERIA II- INFRASTRUCTURE AND LEARNING RESOURCES**

#### **4.1: Physical Facilities**

##### **Metric No. – 4.1.1**

##### **Availability of adequate infrastructure and other facilities**

Teaching – learning, viz., classrooms, laboratories, computing equipment etc.

ICT – enabled facilities such as smart class, LMS etc.

Facilities for Cultural and sports activities, yoga centre, games (indoor and outdoor),  
Gymnasium, auditorium etc.



Atul Vidya Mandir, Wardha's  
**Rajarshee Shahu Science College**

Virul Road, Chandur Rly, Dist. Amravati PIN - 444 904

(College Code : 807)

PRESIDENT

Prof. Mrs. Uttaratai V. Jagtap

SECRETARY

Prof. Virendrabhau W. Jagtap

PRINCIPAL

Dr. M.P. Chikhale

Website : [www.rssc.edu.in](http://www.rssc.edu.in) | Email : [rajarsheeshahucollege@rediffmail.com](mailto:rajarsheeshahucollege@rediffmail.com) | [rsscprincipal@gmail.com](mailto:rsscprincipal@gmail.com) | ☎ (Office) 07222-254111

Ref. No. RSSC/132/23

Date: 17.03.2023

**Declaration**

The information, reports, true copies of the documents, numerical data, etc furnished in this file is verified by IQAC and found correct.

  
IQAC Co-ordinator  
Rajarshee Shahu Science College  
Chandur Rly., Dist. Amravati

(Dr. Minal Keche)

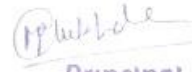

  
Principal  
Rajarshee Shahu Science College  
Chandur Rly., Dist. Amravati

(Dr. Mahesh Chikhale  
Chairman IQAC and Principal)

## Adequate Infrastructure and Other Facility

## 4.1.1

CONTENT	Page No.
<p>The Institution has adequate infrastructure and other facilities for:</p> <ul style="list-style-type: none"> <li>• Teaching – learning, viz., classrooms, laboratories, computing equipment etc</li> <li>• ICT – enabled facilities such as smart class, LMS etc.</li> <li>• Facilities for Cultural and sports activities, yoga centre, games (indoor and outdoor), Gymnasium, auditorium etc</li> </ul>	
❖ Details of the facilities available in the College	2-4
❖ Teaching – learning, viz., classrooms, laboratories & etc.	
• Building Map, College Campus	5-7
• Administrative office (Principal, Office, IQAC)	8-9
• Classrooms	10-12
• Laboratories & Library	13-18
• Seminar Hall & Botanical Garden	19-21
• Biomass compost Plant, Roof Rainwater Harvesting Plant & Roof Top Solar Plant	21-22
❖ ICT – enabled facilities	23-28
• Facilities for Cultural and Sports activities, yoga centre, games (indoor and outdoor), Gymnasium, NSS, Parking etc	
• Cultural, Sport, Yoga, Games, Gymnasium & etc.	29-31
❖ NSS, Parking Area, Relaxation/dressing	32-35
❖ Other Facility: Health & Hygiene	36-38

### Details of the facilities available in the College

The institution has adequate facilities as per the norms of Department of Higher and Technical Education, Maharashtra State. The institution has the following infrastructure facilities:

**Total Campus Area: 7018sq m**

**Build up area: 2305.81sq m**

❖ **Administrative :-**

Room	Require Area (sq. ft.)	Available Area (sq. ft.)
Principal	500	400
Office	500	500
IQAC	150	400

❖ **Classroom:-**

Classrooms	Require Area (Sq. ft.)	Available Area/ Classroom (Sq. Ft.)	No. of classroom	Total Area (sq. ft.)
S1, S2, S3, S4	--	600	4	2400
S5, S6, F11	--	900	3	2700
<b>Total</b>			<b>7</b>	<b>5100</b>

❖ **Laboratories and Library:**

The college is having six laboratories and a library as per following specification-

Laboratory/ Library	Require Area (sq. ft.)	Available Area (sq. ft.)
Chemistry	1200	1200
Physics	1200	1400
Botany	1200	1200
Zoology	1200	1200
Computer Science	600	450
Electronics	600	450
Library	600	900

❖ **Multipurpose Hall( Late Atul Jagtap Memorial Hall):-**

The college has 1800 sq. ft. ICT enabled multipurpose hall with seating capacity of 200.

- ❖ **Botanical Garden:** 3680 sq. ft.
- ❖ **Biomass compost Plant:** 90 sq. ft
- ❖ **Roof Rainwater Harvesting Plant** : 6000sq. ft.
- ❖ **Roof Top Solar Plant** (05 KW): Raajratna Ventures LTD 310 wp 18nos modules with Polycab On Grid Inverter. Manufactured by ECE (India) Energies Pvt. Ltd. Amravati.
- ❖ **ICT Facilities:**

The institute is having 28 computers, 1 Photostat, internet connections, Wi-Fi Routers, 52 access internet points, 5 Printers, 2 Scanners with Printer, 16 CCTV Cameras with one LED Screen and 5 LCD projectors. One LCD projector is fixed in multipurpose hall and four projectors kept mobile and are used by the teachers as ICT tool for teaching purpose.

- Number of classrooms with Wi-Fi/LAN facilities: **07**
- No. of Laboratories with Wi-Fi and internet facilities: **06**
- Library is equipped with four computer systems.
- **LMS:** The College has paid subscription of G-Suite. This online platform is used by all the teaching staff for teaching and learning purpose. Library software-LibMan (Master Software) with MOPAC, N-LIST, NDLI e-resources are available. Downloaded e-books and educational CD's are available in the Library.

❖ **Other Facilities :**

The College is having open dais, multipurpose hall for cultural activities, playground, gymnasium, sports & games facility, etc. as figure out below-

Sr. No.	Activity	Facility	Area (sq. ft.)	Establishment Year	User rate
1	Games & Sports	Play grounds (Kabaddi, Cricket, Volleyball, Football, Hockey, Chess, Carom & etc.)	20000	2008	150
2	Workout	Gymnasium	1100	2020	15
3	Cultural Activities / Yoga	Multipurpose Hall,	1800	2010	200
		Open dais	14097	2008	600
4	NSS	NSS office	100	2011	100
5	Parking	Vehicle Parking Area	5250	2010	300
6	Relaxation/ dressing	Girls Common Room	250	2016	10

❖ **Health and Hygiene :**

- Safe drinking water purifier (Aqua Sure and Aqua guard Classic)
- Water cooler is provided in the college (Voltas Water Cooler).
- First aid box
- Dustbins are placed at every floor.
- Vending Machine
- Clean lavatories for students & staff.
- Fire extinguishers.
- Sanitizer with stand

## Infrastructure & Physical Facilities

The institution has adequate facilities as per the norms of Department of Higher and Technical Education, Maharashtra State. The institution has the following infrastructure facilities:

**Total Campus Area: 7018sq m**

**Build up area: 2305.81sq m**

### Budling Map

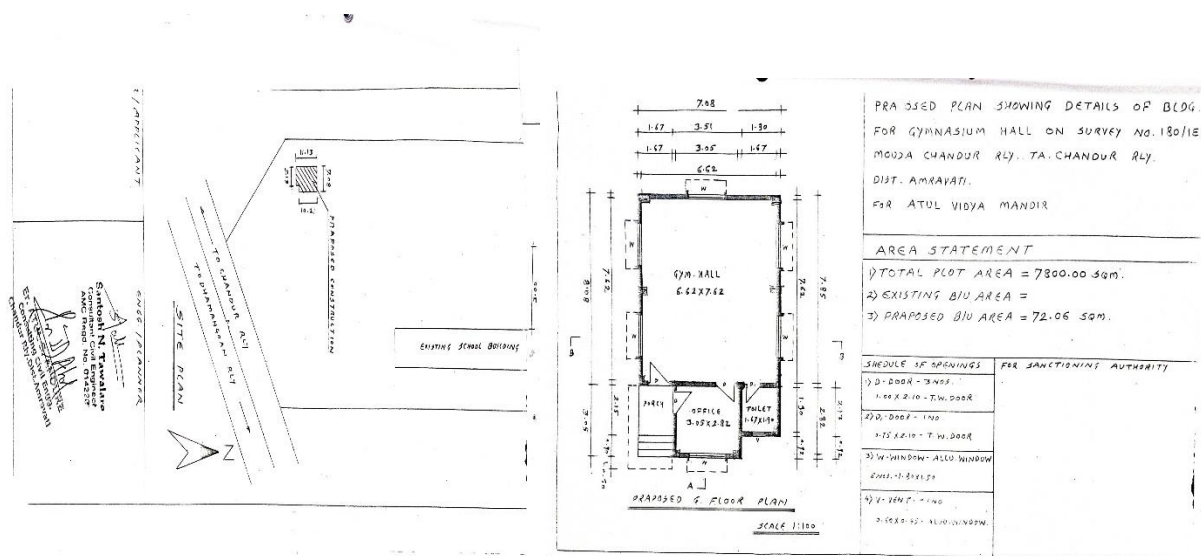
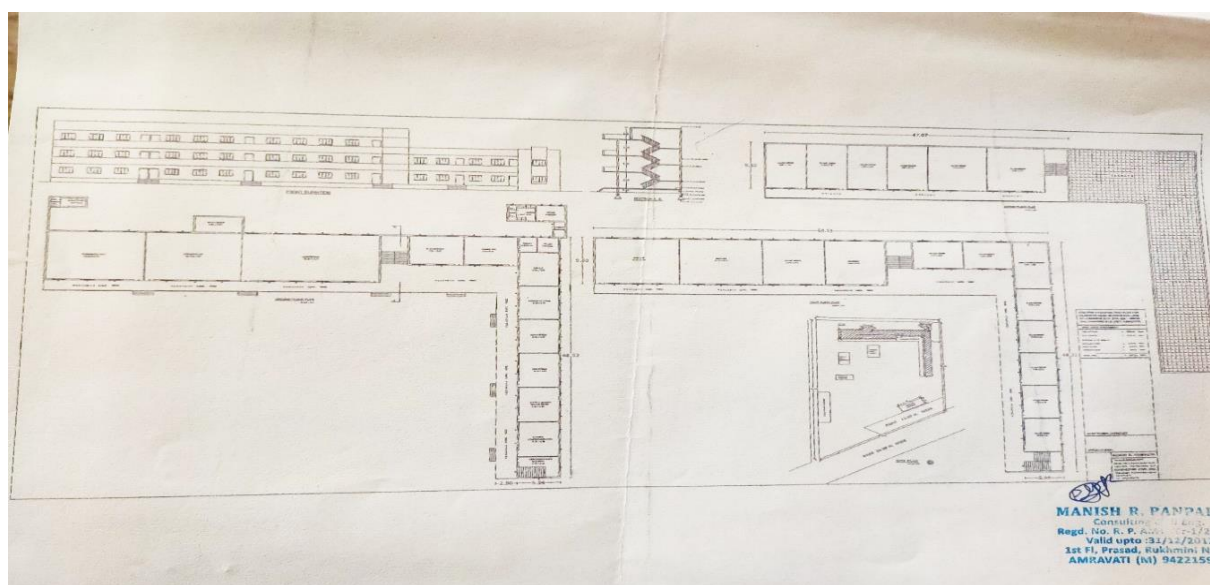

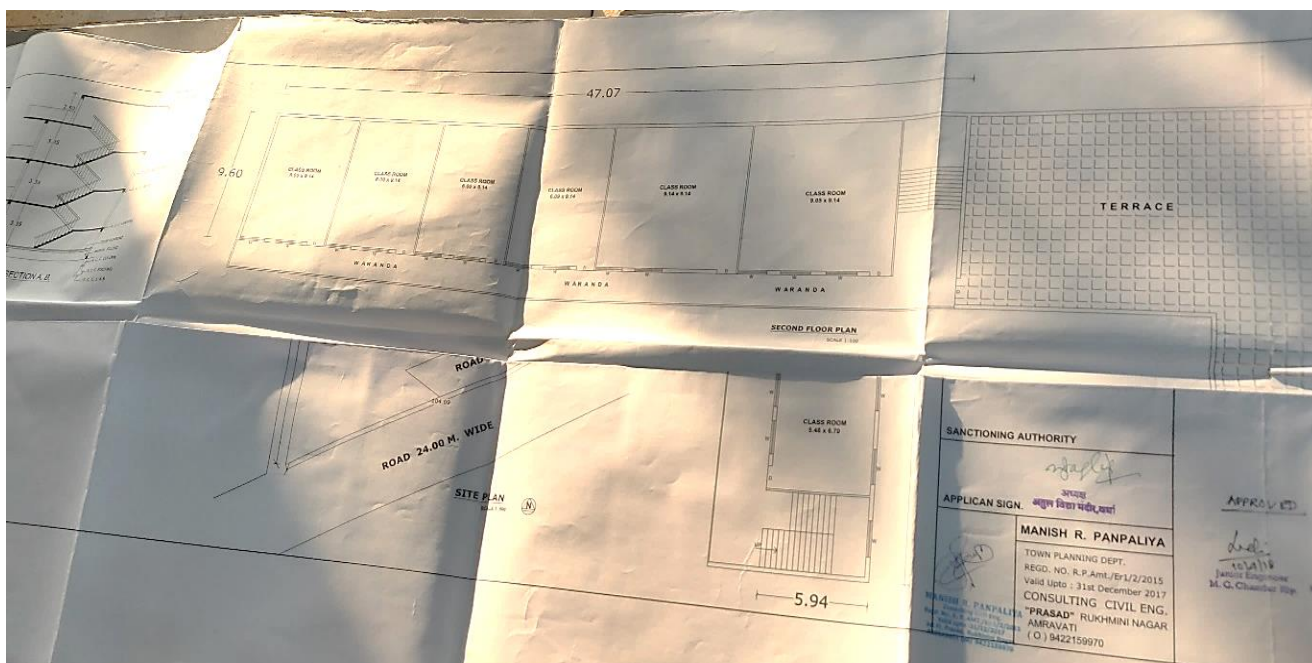
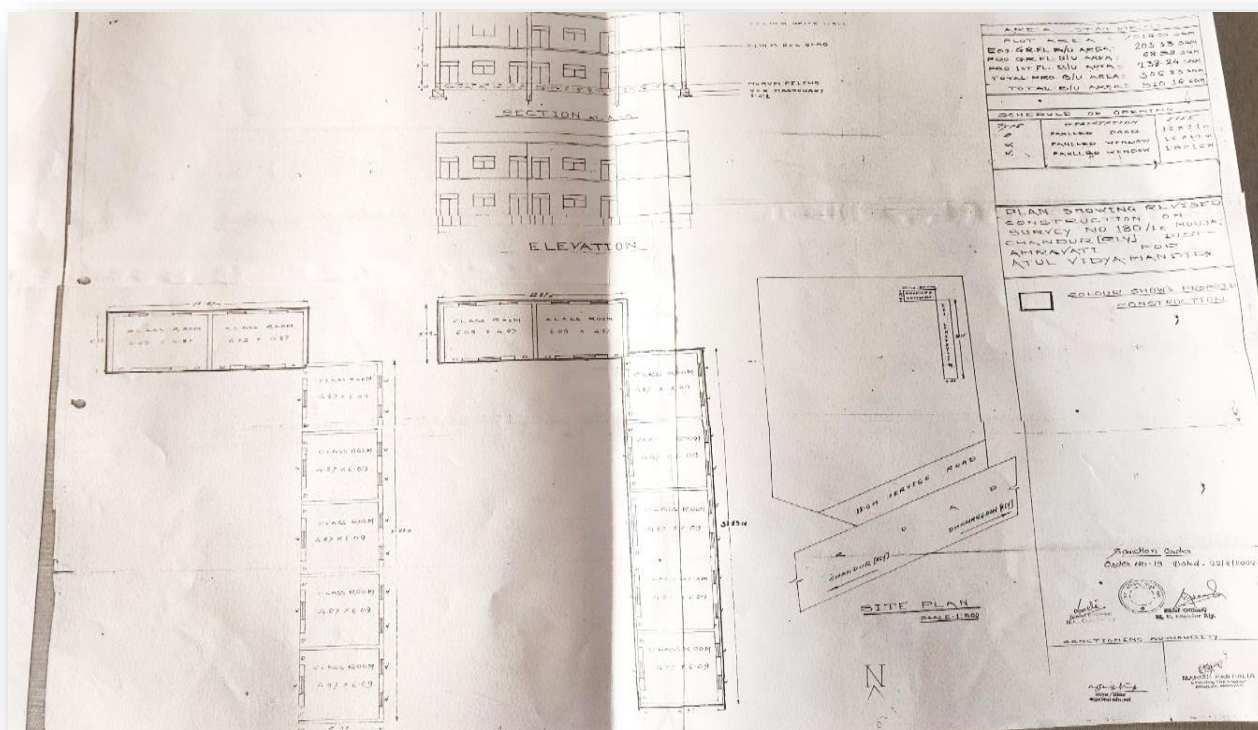

## College Campus

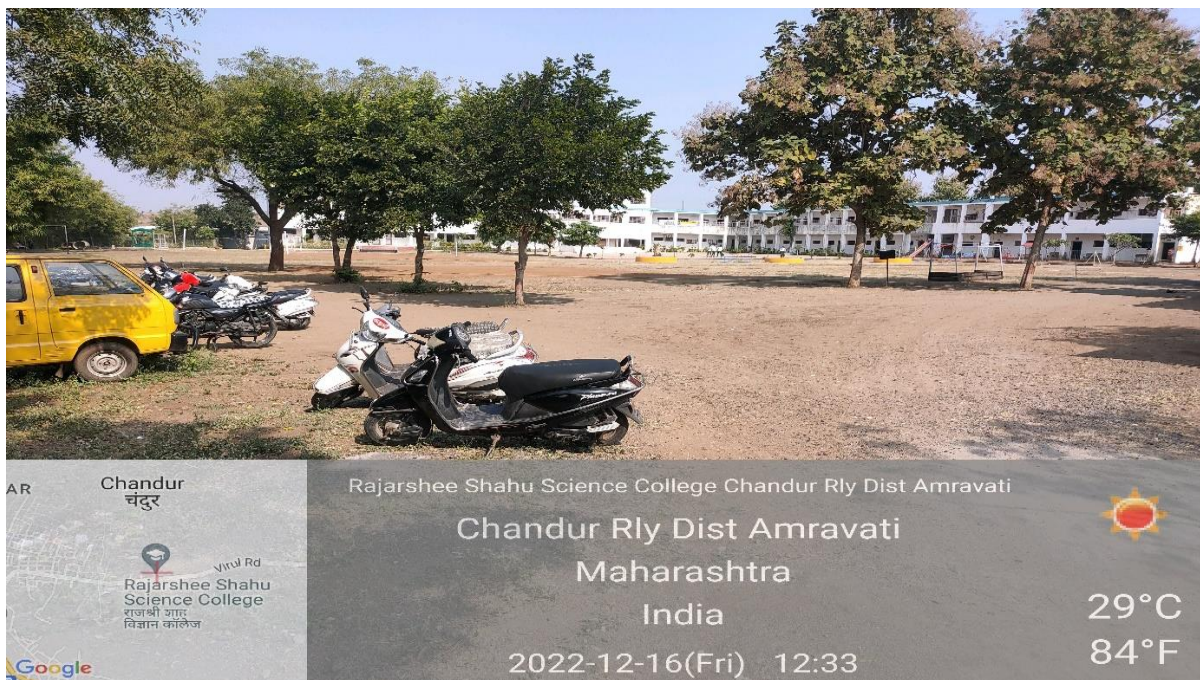

Administrative:-

Room	Available Area (sq. ft.)
Principal	400
Office	500
IQAC	400

Principal Cabin



Office

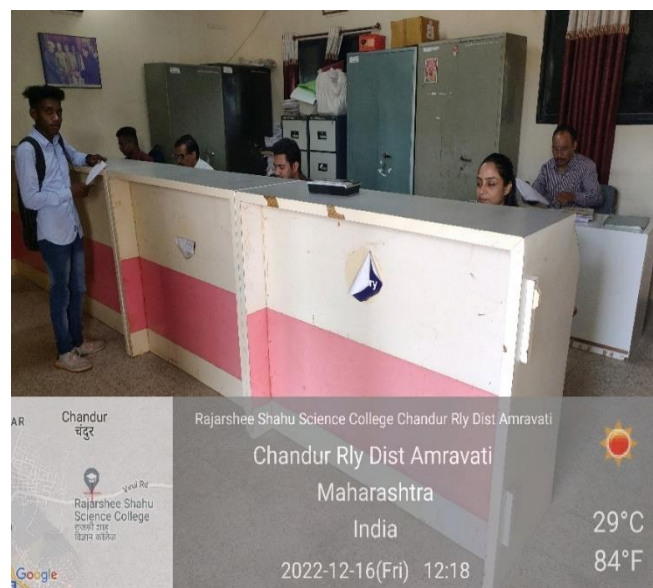

IQAC Office



## Classrooms

Classroom	Available Area (Sq. Ft.)	No. of Classroom	Total Area (sq. ft.)
S1, S2, S3, S4	600	4	2400
S5, S6, F11	900	3	2700
Total		7	5100



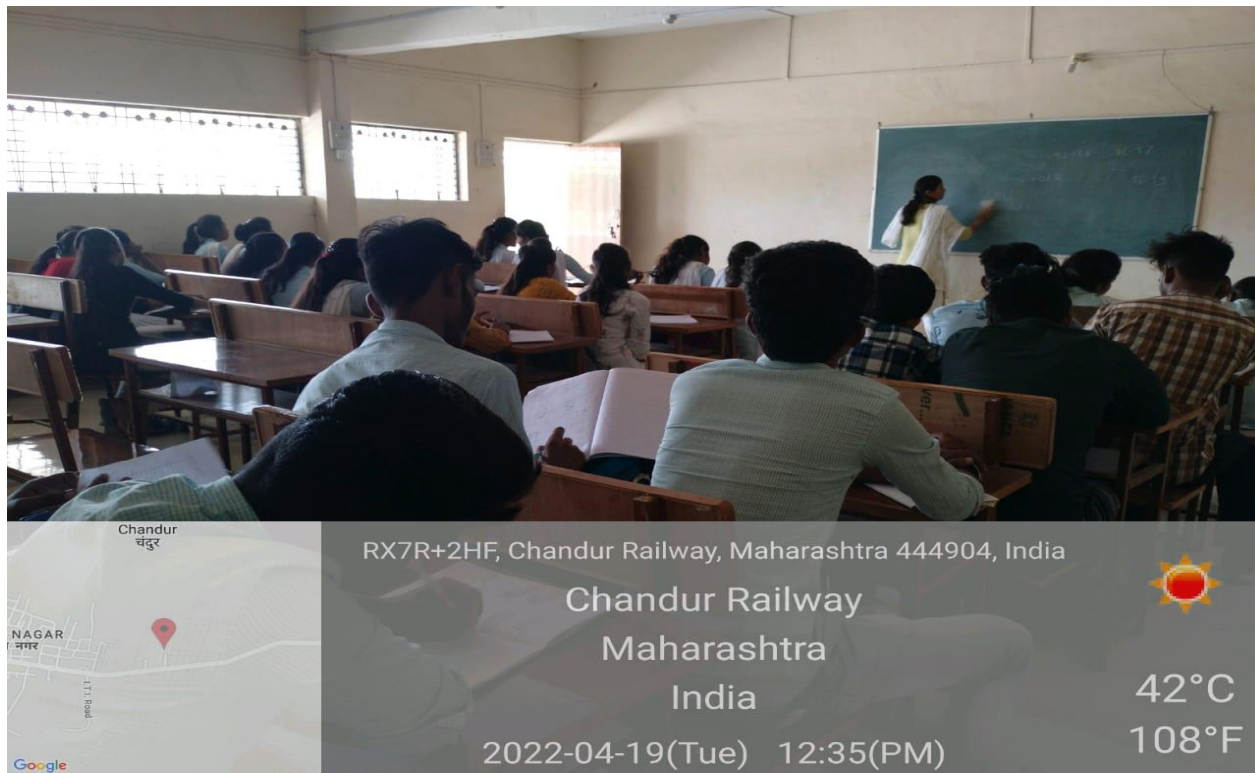



RX7R+2HF, Chandur Railway, Maharashtra 444904, India

Chandur Railway  
Maharashtra  
India

2022-04-18(Mon) 11:57(AM)



2022-12-08(Thu) 01:18(PM)

## Laboratories & Library

Laboratory/ Library	Available Area (sq. ft.)
Chemistry	1200
Physics	1400
Botany	1200
Zoology	1200
Computer Science	450
Electronics	450
Library	900

### Chemistry

### HOD & Staff Compartment

### Instrumentation Compartment

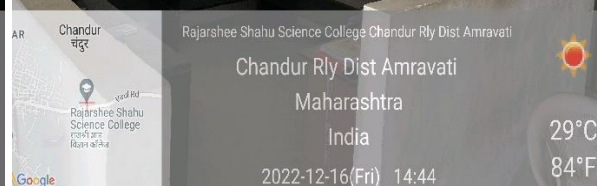
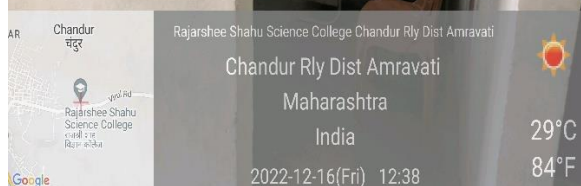
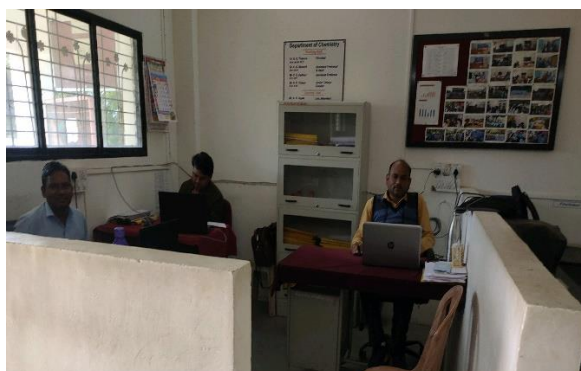

### Store Room

### Lab



## Physics

### HOD & Staff Compartment

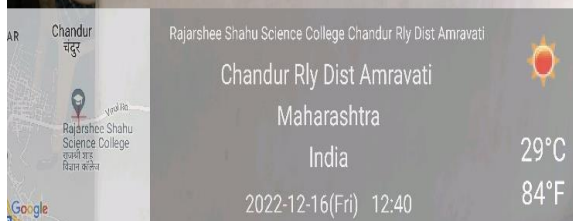

### Store Room

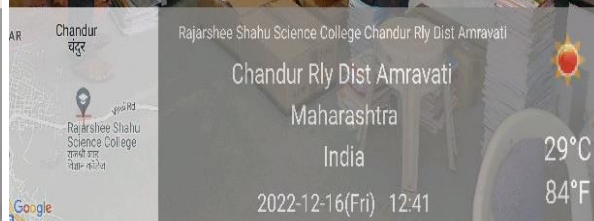

### Dark Room

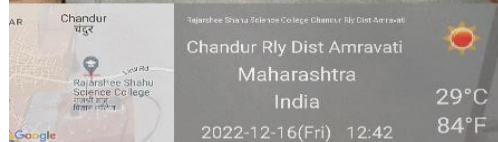

### Lab

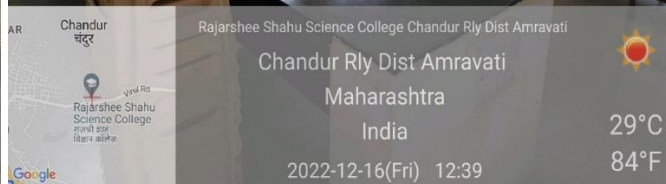

## Botany

### HOD & Staff Compartment

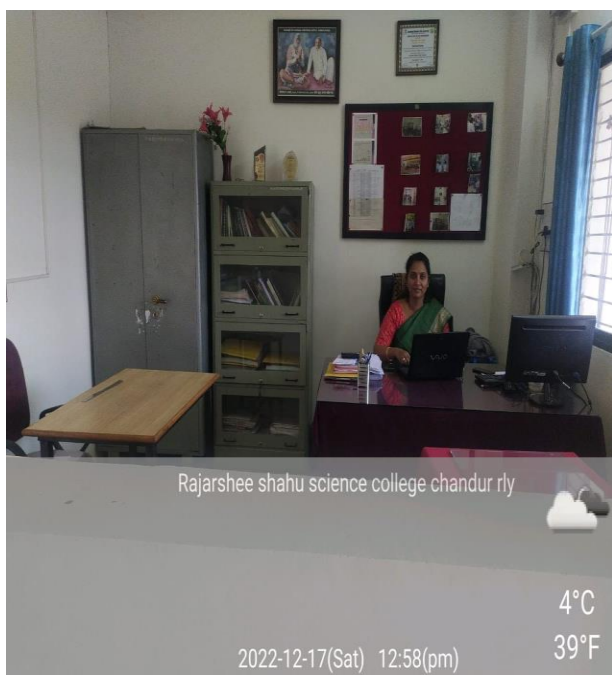

### Research Lab



### Store Room



### Lab



## Zoology

### HOD & Staff Compartment

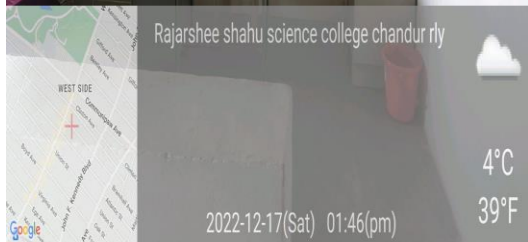
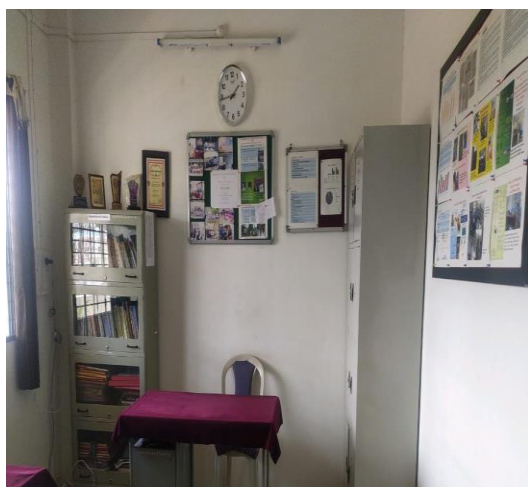

### Store Room

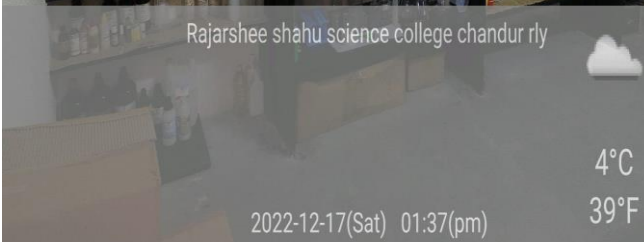

## Lab



## Computer Science

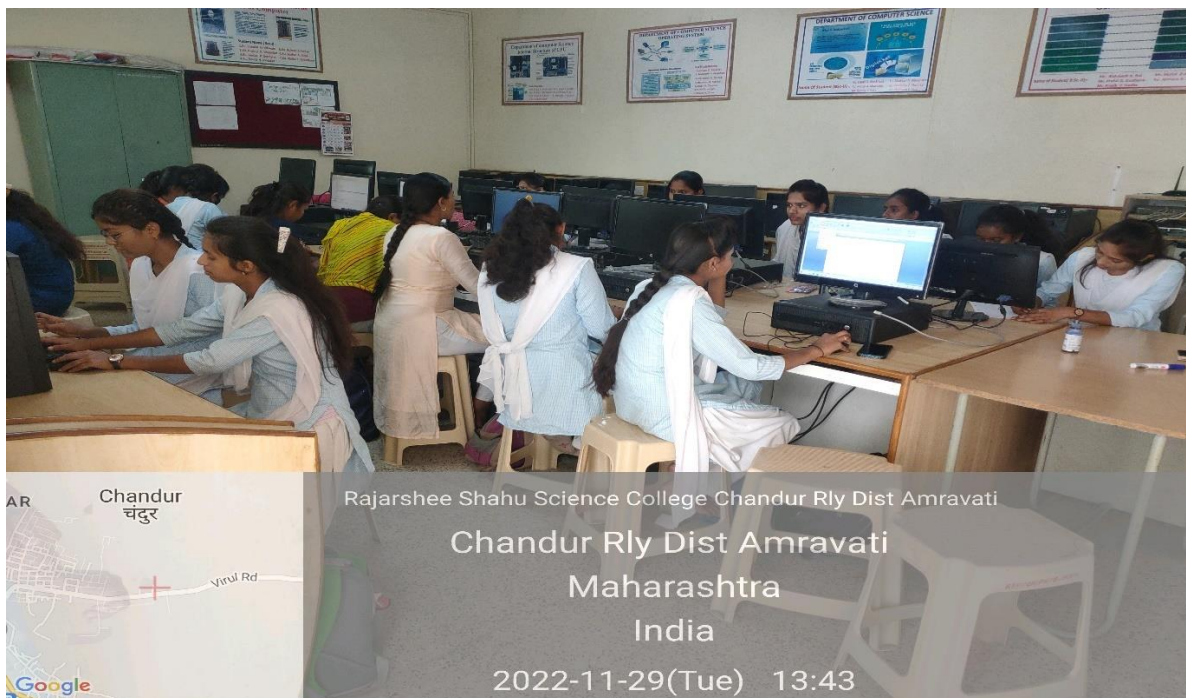

## Electronics



## Library

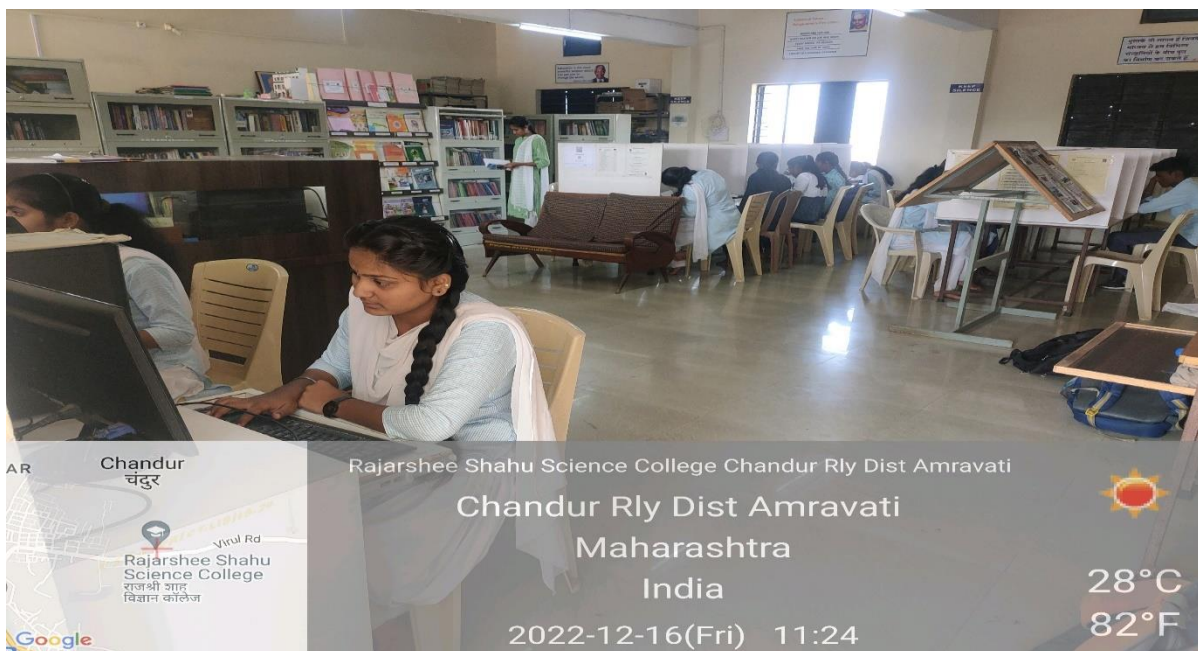
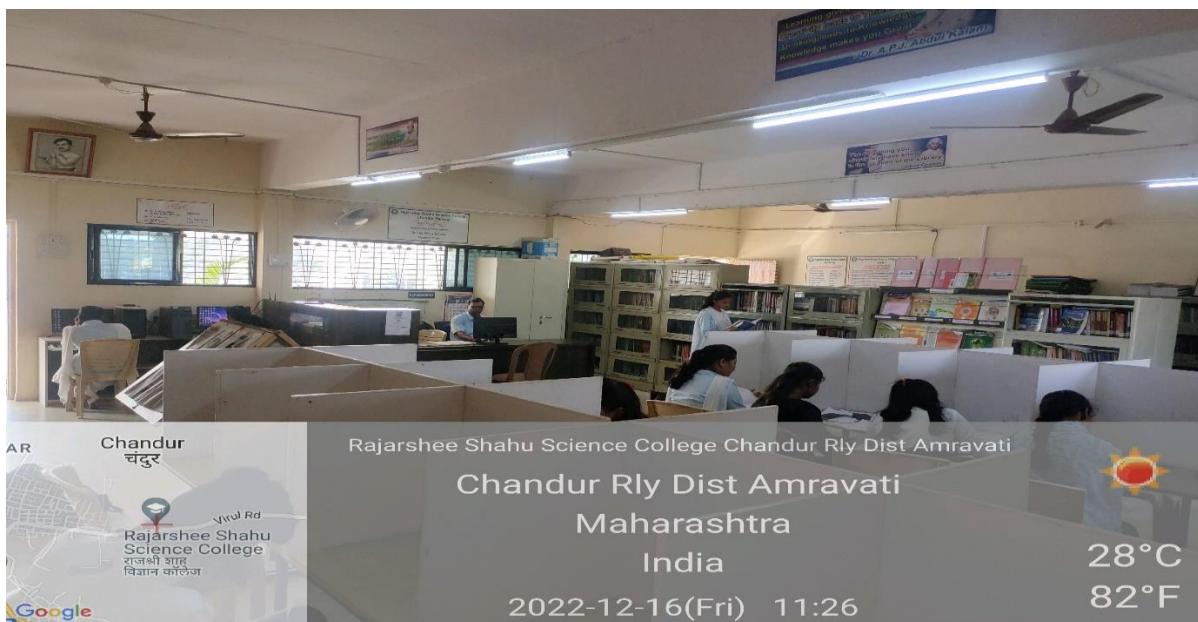

## Seminar Hall Late Atul Jagtap Memorial Hall

The college has 1800 sq. ft. ICT enabled multipurpose hall with seating capacity of 200.





## Botanical Garden

**Botanical Garden:** 3680 sq. ft.

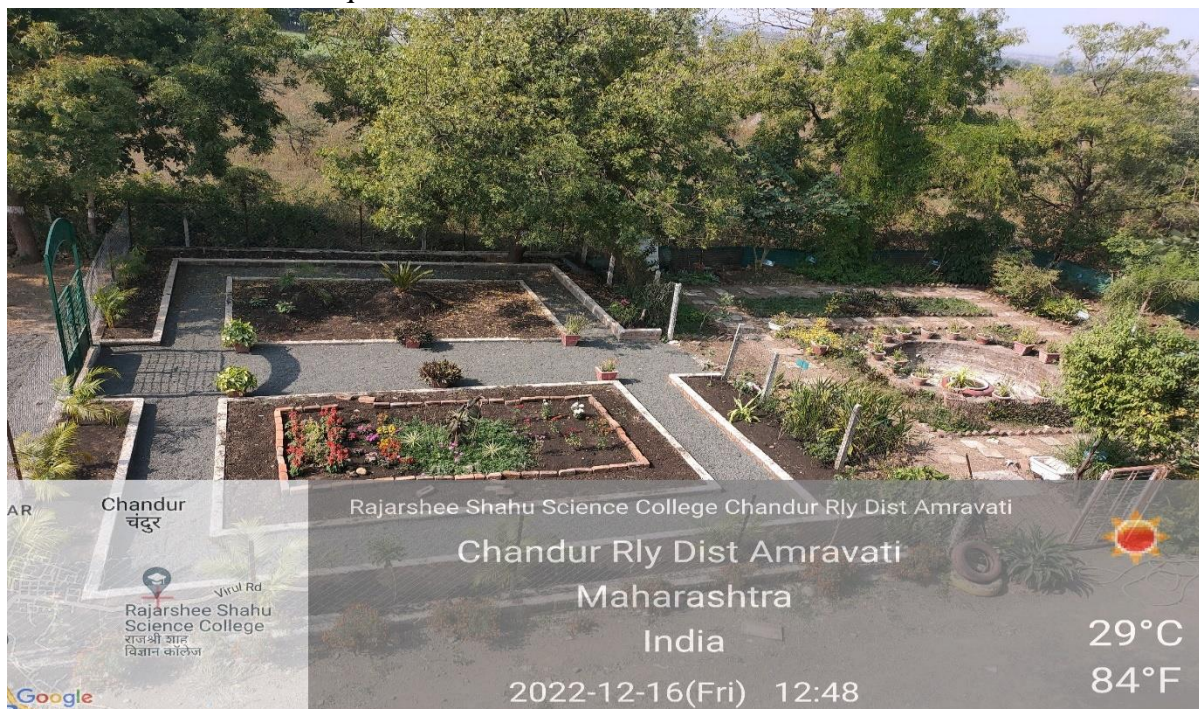

**Biomass compost Plant:** 90 sq. ft

## Biomass compost Plant



### Roof Rainwater Harvesting Plant

**Roof Rainwater Harvesting Plant** : 6000 sq. ft.



### Roof Top Solar Plant

**Roof Top Solar Plant** : (05 KW) Raajratna Ventures LTD 310 wp 18nos modules with Polycab on Grid Inverter. Manufactured by ECE (India) Energies Pvt. Ltd. Amravati.



## ICT Facilities

The institute is having 28 computers, 1 Photostat, internet connections, Wi-Fi Routers, 52 access internet points, 5 Printers, 2 Scanners with Printer, 16 CCTV Cameras with one LED Screen and 5 LCD projectors. One LCD projector is fixed in multipurpose hall and four projectors kept mobile and are used by the teachers as ICT tool for teaching purpose.

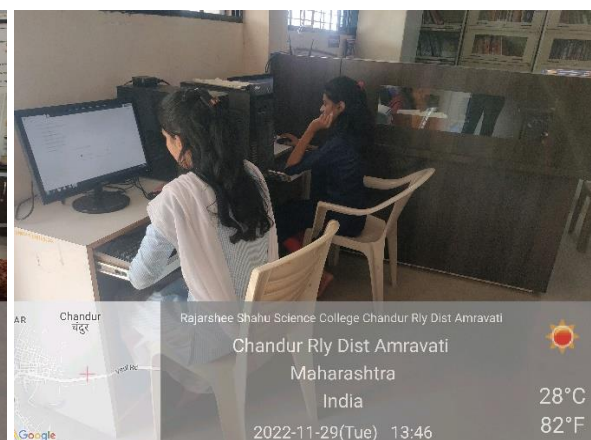
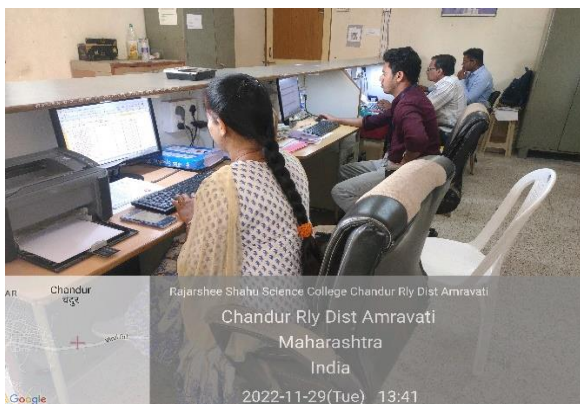

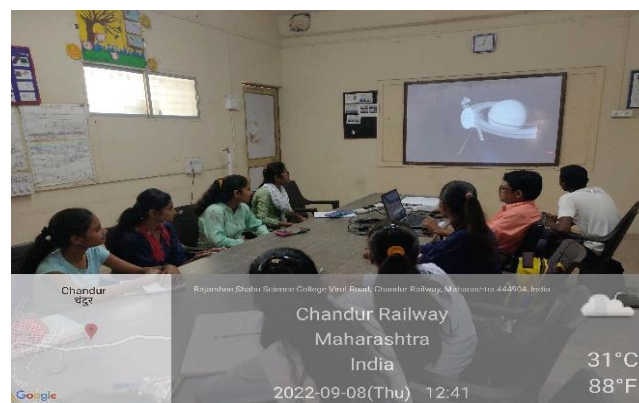
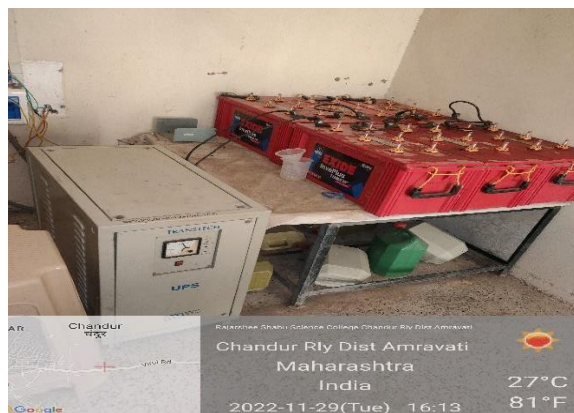

## LMS (Learning Management System)

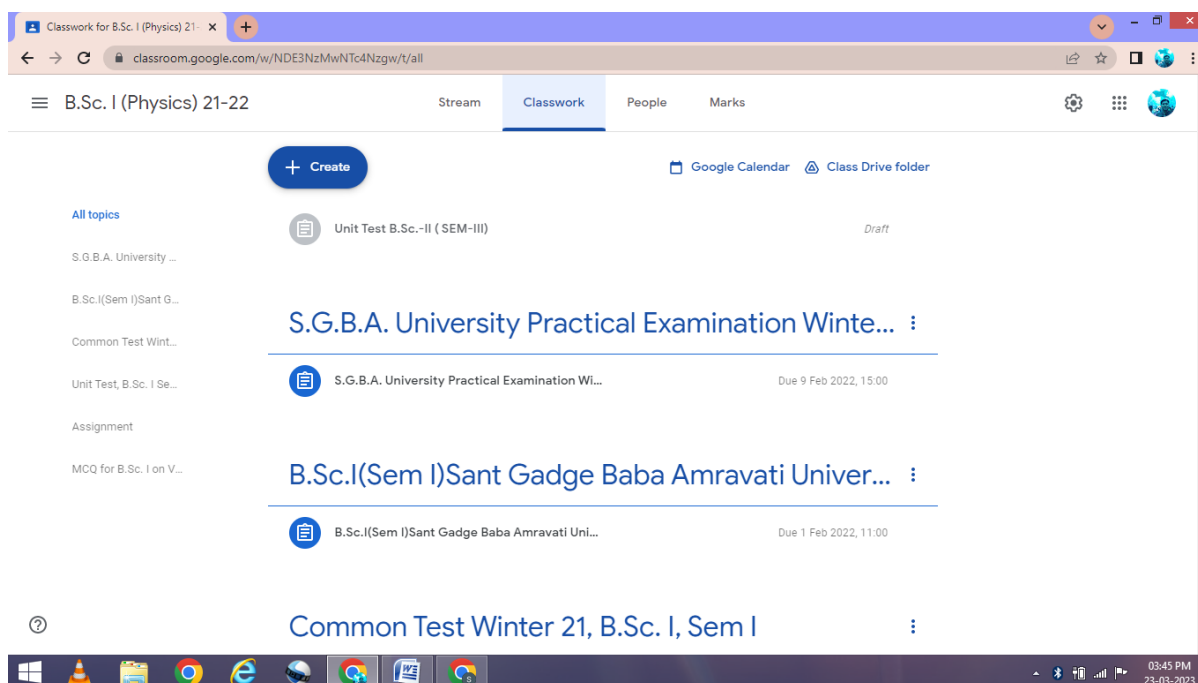
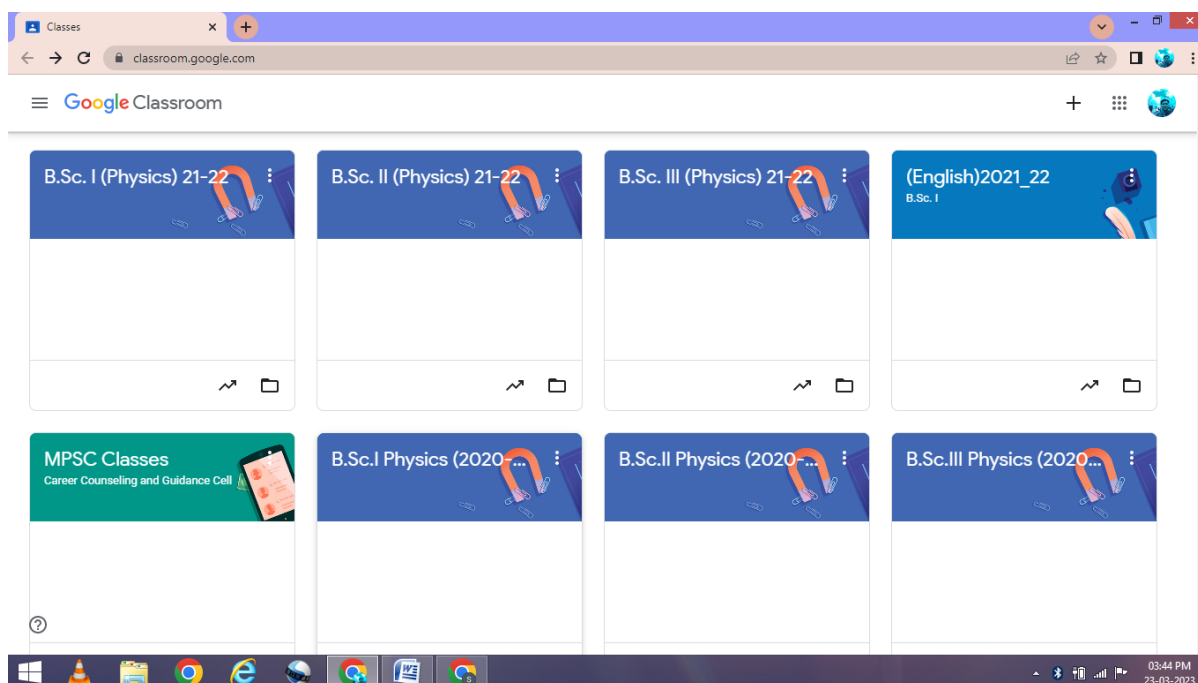

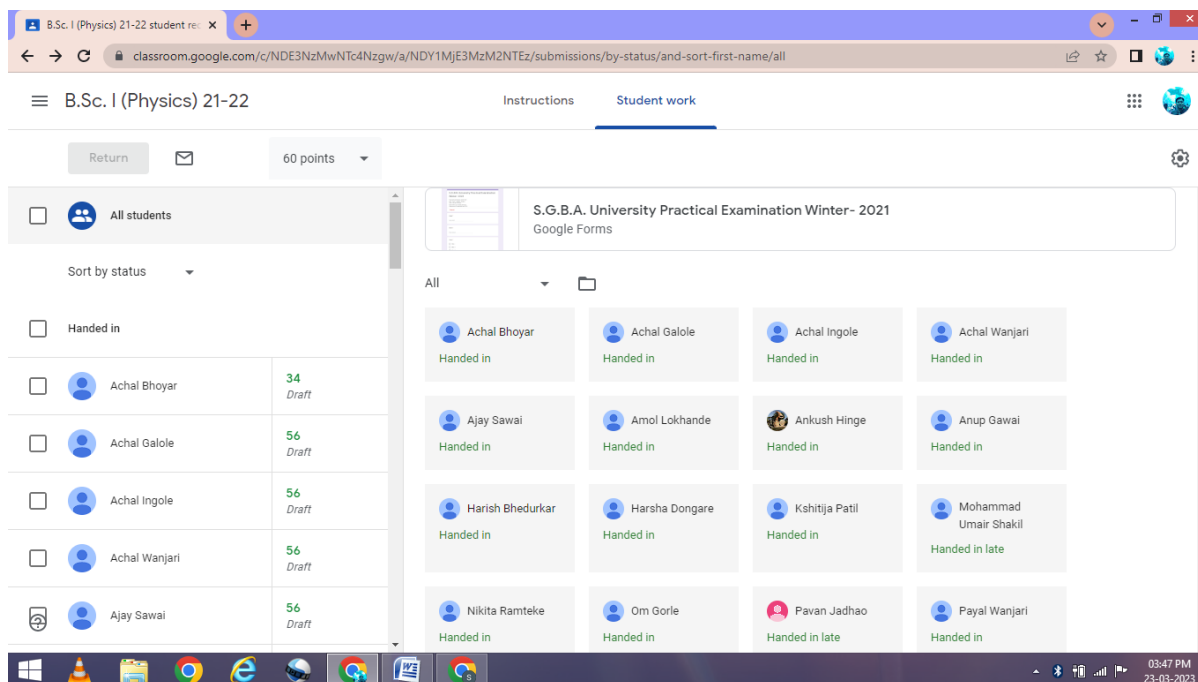
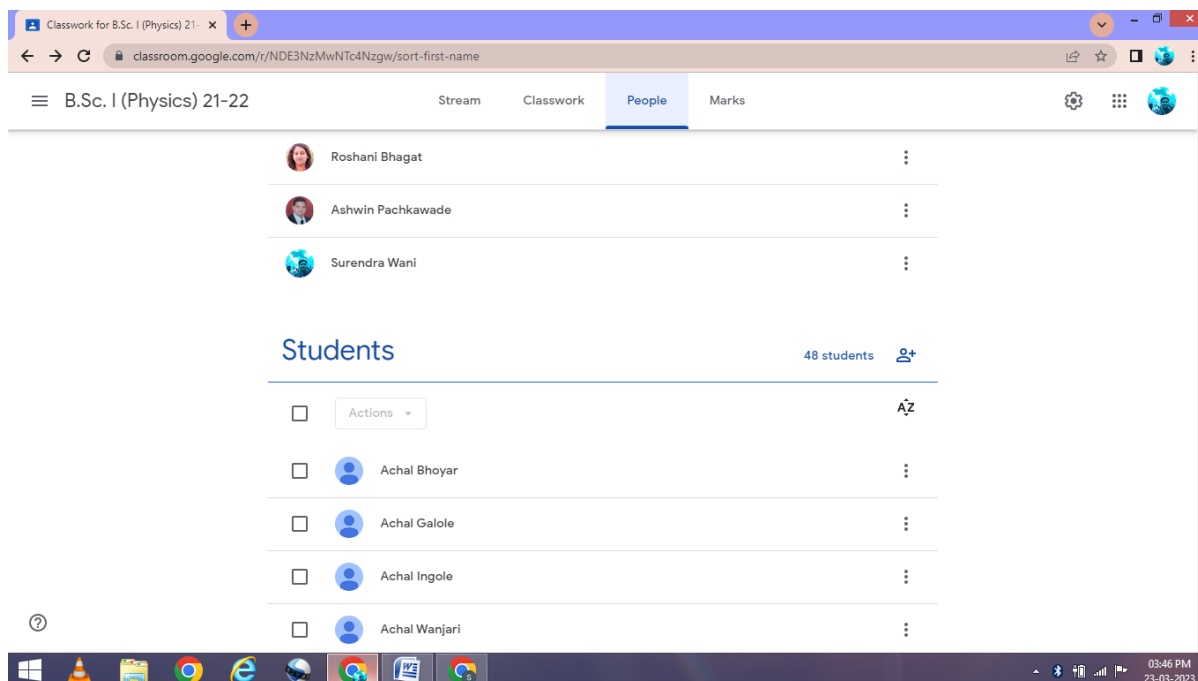

National Digital Library of India

24/11/2018

Gmail - Approval of request of Rajarshee Shahu Science College for Institutional registration in NDL India



Manoj Waghmare <rssclibrary@gmail.com>

**Approval of request of Rajarshee Shahu Science College for Institutional registration in NDL India**

1 message

NDL-Support <ndl-support@iitkgp.ac.in>  
To: rssclibrary@gmail.com

Mon, Aug 7, 2017 at 4:48 PM

Dear Manoj Waghmare,

Your request for Institutional registration facility in NDL India is approved. Please register all the users (students, research scholars, faculty members and staff) of Rajarshee Shahu Science College, who are not yet registered in NDL India, by clicking the "Add User" button of the NDL India portal available to you after you login to NDL India (<https://ndl.iitkgp.ac.in>).

There are two options: Single User Registration and Bulk User Registration. Single User Registration is self-explanatory. For Bulk User Registration please prepare CSV file, strictly as per the following format, and then upload the file:

- e-mail id (of user)\*
- First Name (of user)\*
- Last Name (of user)

Note that the e-mail id and First Name are mandatory for each person but Last Name is optional. Also there should not be more than 1000 (One Thousand only) users in a CSV file. The registration process gets completed once the registration mails are sent to all the users listed in the file. It may take some time to complete this mail sending process and you may observe the status in the tab "Status".

In case you need to register more than 1000 users, please do this by making multiple files, each file not containing more than 1000 users, and uploading each file separately, and one by one. The next file should be uploaded only when the registration process for the previous file is completed, which may be confirmed from the "Status" tab.

Since new students, faculty, staff join every 6 months, please collect details of new users enrolled in Rajarshee Shahu Science College every 6 month period and get them registered in NDL India.

If you face any problem or need any clarification, please get in touch with us at [ndl-support@iitkgp.ac.in](mailto:ndl-support@iitkgp.ac.in).

We solicit your cooperation in getting all users of Rajarshee Shahu Science College registered in NDL India regularly.

Let's all enjoy NDL India!

Best Regards,

The NDL India team

<https://mail.google.com/mail/u/0/?ik=f0b6a9e518&view=pt&search=all&permthid=thread-f%3A1575070722977405336&simpl=msg-f%3A1575070722977405336> 1/1

## N-LIST



## Information and Library Network Centre

(An Autonomous Inter-University Centre of UGC)

सूचना एवं पुस्तकालय नेटवर्क केन्द्र

(विश्वविद्यालय अनुदान आयोग का स्वायत्त अंतर विश्वविद्यालय केन्द्र)

## National Library and Information Services Infrastructure of Scholarly Content (N-LIST)

## Invoice

Ref No.: INF/N-LIST/2018/6755

Date: 2018-05-22

Invoice No.: NLIST/18-19/988

College GST No.: Not Available

College GST State Code: MH [27]

## Name and Address of Subscriber

To  
The Principal  
Rajarshee Shahu Science College  
Virul Road, Chandur Railway  
Amravati  
Maharashtra - 444904

SR. No.	Membership Fee	Period of Membership	Amount In Rs
1	N-LIST Annual Membership Fee	April 2018 to March 2019	5,000.00
		CGST@0.00%	0.00
		SGST@0.00%	0.00
		IGST@18.00%	900.00
		<b>Total</b>	<b>5,900.00</b>

Rupees Five Thousand Nine Hundred Only

GSTIN: 24AAAT11480J1ZS

TDS is not applicable on annual membership fee.

Sincerely Yours

Ashok Kumar Rai  
Scientist-E(CS)

----- Cut Here -----

## N-LIST MEMBERSHIP FEE RECEIPT

Receipt Date: 2018-05-22

Receipt No: 474

## Received with thanks from Rajarshee Shahu Science College, Amravati, Maharashtra

A sum of Rupees Five Thousand Nine Hundred Only by Cheque No/DD No/RTGS No. 777423 Dated 2018-04-20 drawn on Bank of Maharashtra Payable at Gandhinagar Gujarat towards N-LIST Annual Membership Fee for the financial year 2018-19.

**Rs. 5900**

Sincerely Yours

For Administrative Officer(PA &amp; F)

This receipt is valid on realization of Cheque and DD.

Subject to Gandhinagar(Gujarat) jurisdiction only

Online Printed Date : 2021-10-28 07:19:44

INFLIBNET Ref No : INF/N-LIST/2018/6755

GSTIN. 24AAAT11480J1ZS.

Infocity, P.B. No. 4, Gandhinagar - 382007, Gujarat, INDIA

इन्फोसीटी, पो.बो. नं. ४, गांधीनगर - ३८२००७, गुजरात (भारत)

Ph.: +91-79-23268000, Fax : +91-79-23268222, <http://www.inflibnet.ac.in>

## Sport & Cultural

### Other Facilities:

The College is having open dais, multipurpose hall for cultural activities, playground, gymnasium, sports, games, etc. as shown below-

Sr. No.	Activity	Facility	Area (sq. ft.)	Establishment Year	User rate
1	Games & Sports	Play grounds (Kabaddi, Cricket, Volleyball, Football, Hockey, Chess, Carom & etc.)	20000	2008	150
2	Workout	Gymnasium	1100	2020	15
3	Cultural Activities / Yoga	Multipurpose Hall,	1800	2010	200
		Open dais	14097	2008	600
4	NSS	NSS office	100	2011	100
5	Parking	Vehicle Parking Area	5250	2010	300
6	Relaxation/dressing	Girls Common Room	250	2016	10

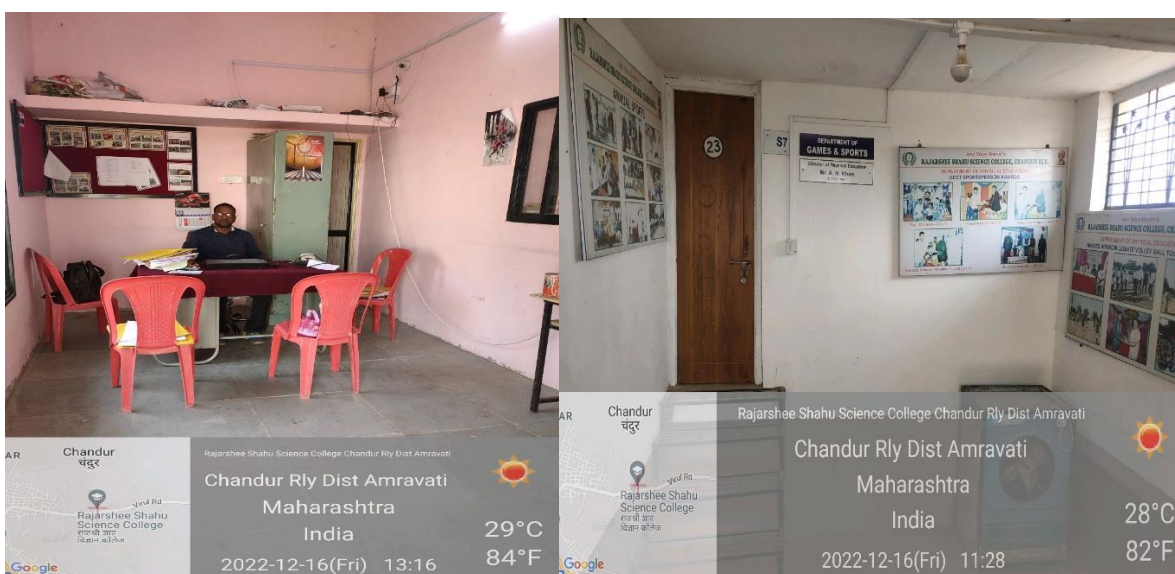

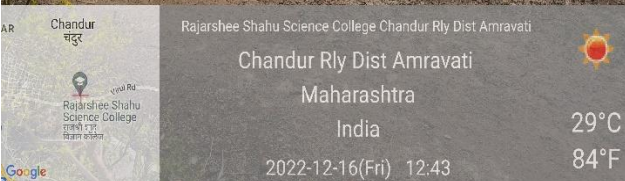
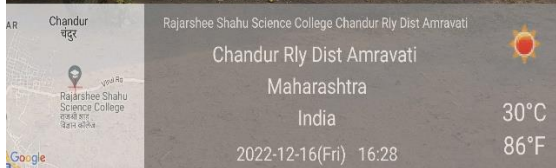



NSS

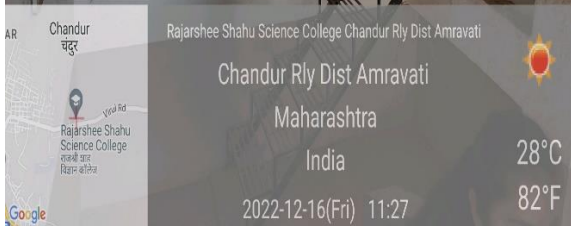

## Parking Area

### Staff Parking



### Cycle Stand for Girls

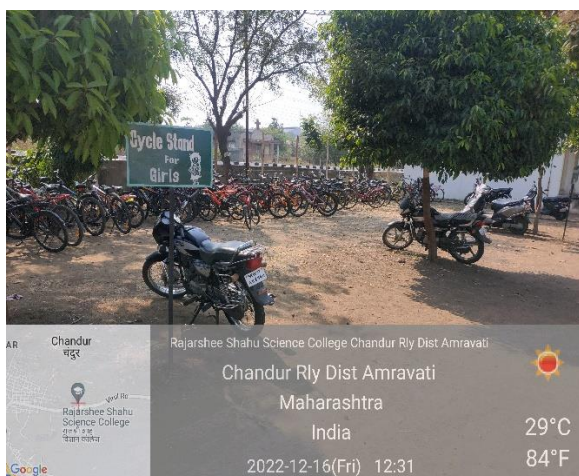

### Cycle Stand for Boys

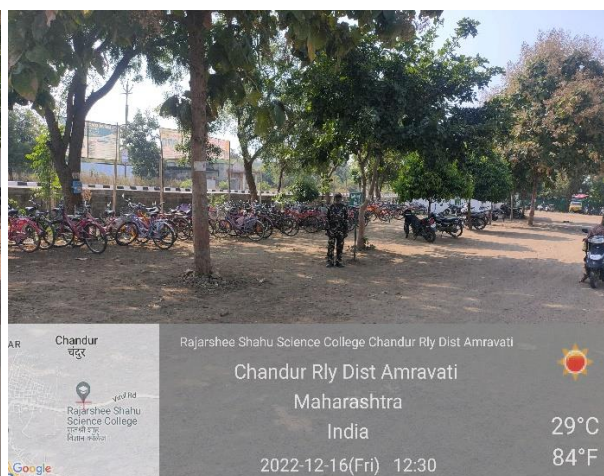

Motorcycle Stand for Girl



Motor Cycle Stand for Boys

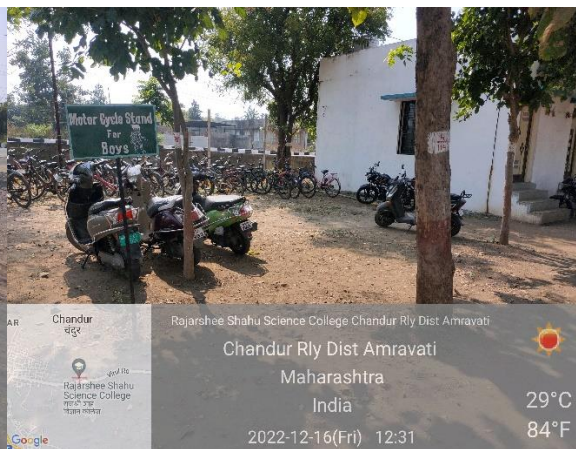

### Relaxation/Dressing Girls Common Room



## Health and Hygiene

- Canteen
- Safe drinking water purifier (Aqua Sure and Aqua guard Classic)
- Water cooler is provided in the college (Voltas Water Cooler).
- First aid box
- Dustbins are placed at every floor.
- Vending Machine
- Clean lavatories for students & staff.
- Fire extinguishers.

## Canteen

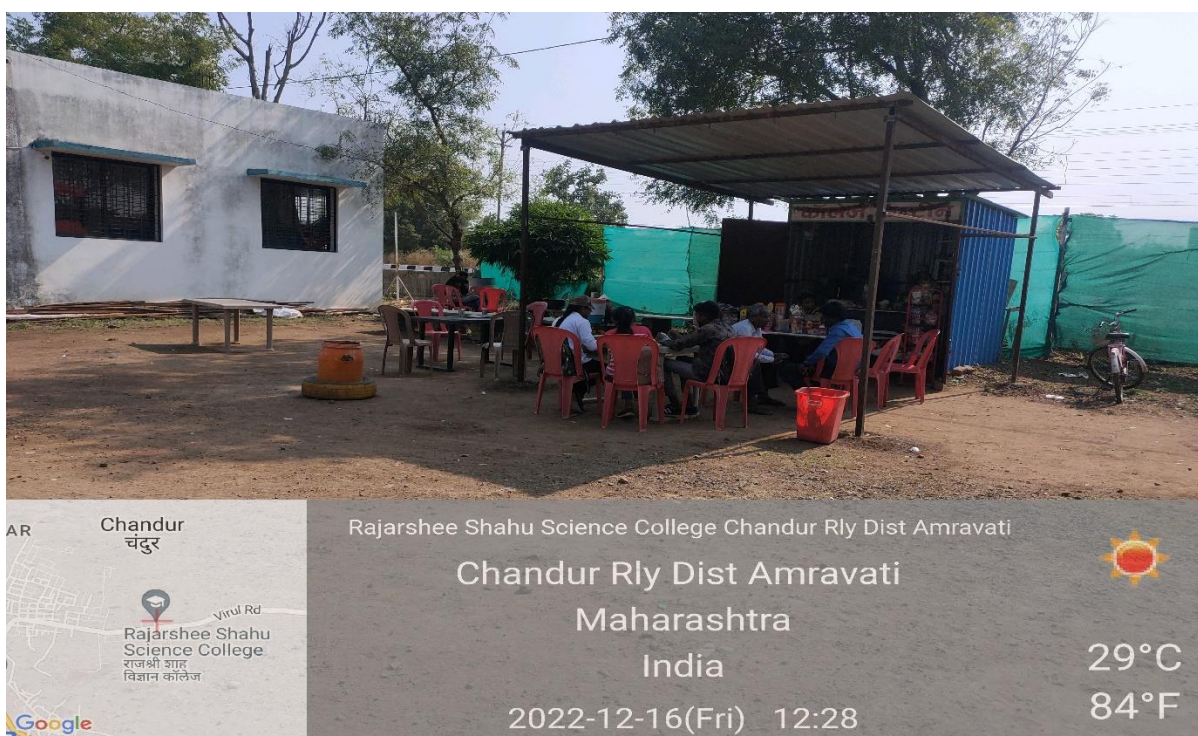

## Drinking Water

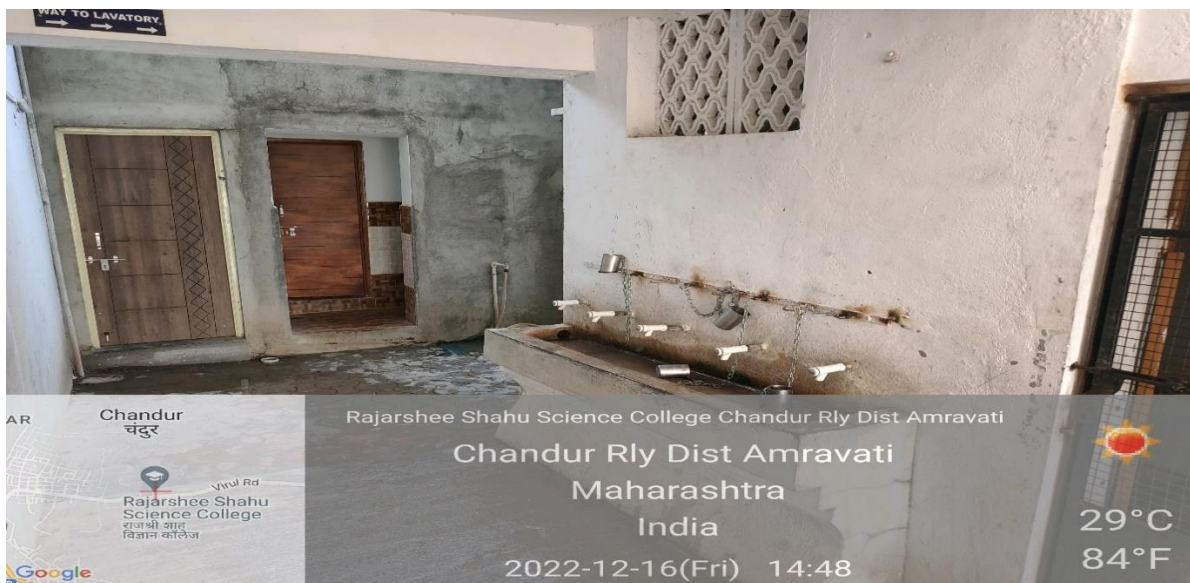

## Clean Lavatories

